

# BUSCH MACHINERY

**KLL**

**PRINTER AND LABEL  
APPLICATOR**

Application speed up to 30m/min  
4" and 6" wide versions  
Aluminum construction with electrostatic paint  
Compatible with Zebra Sato and Datamax  
printing modules



Internal memory to save up to 50 different label formats  
Numeric keypad with LCD display  
Product Counter  
Diagnostic and maintenance configuration menu

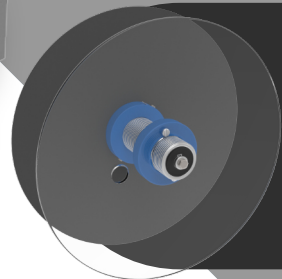

Rolls up to 300 mm in diameter  
76mm inner diameter  
Brake with compensation arm



**Busch Machinery, Inc.**  
727 E. 20th St.  
Tucson, AZ 85719  
Phone: 800-840-9573 (USA Only)  
Fax: 800-840-6270 (USA Only)  
Phone 520-777-3360  
Fax: 520-777-3369  
E-mail: [sales.inquiries@busch-machinery.com](mailto:sales.inquiries@busch-machinery.com)

# BUSCH MACHINERY

Right Version

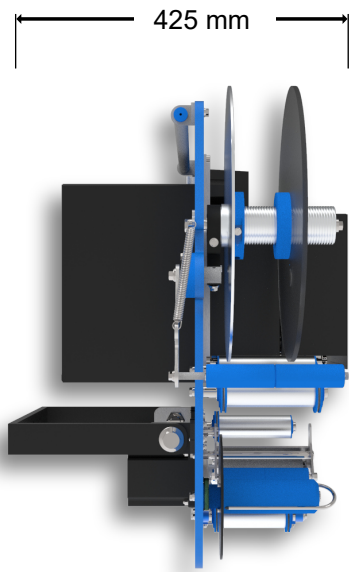
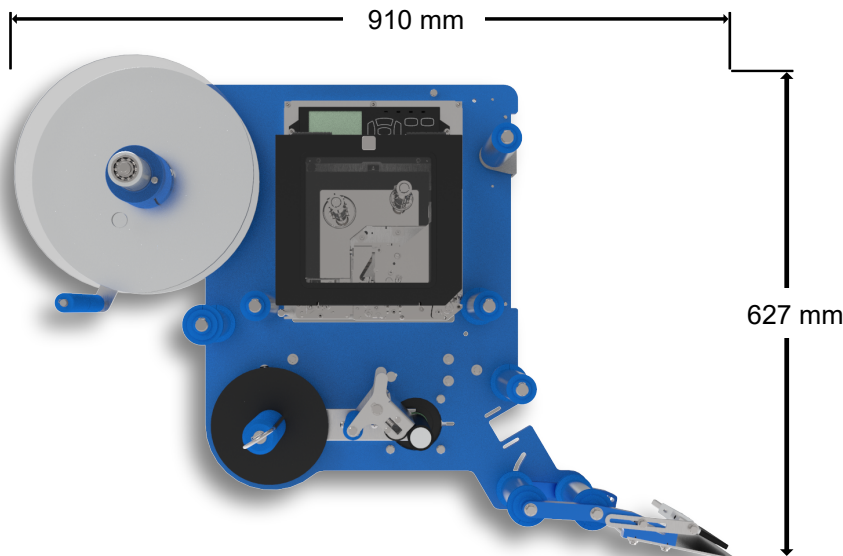

Left Version

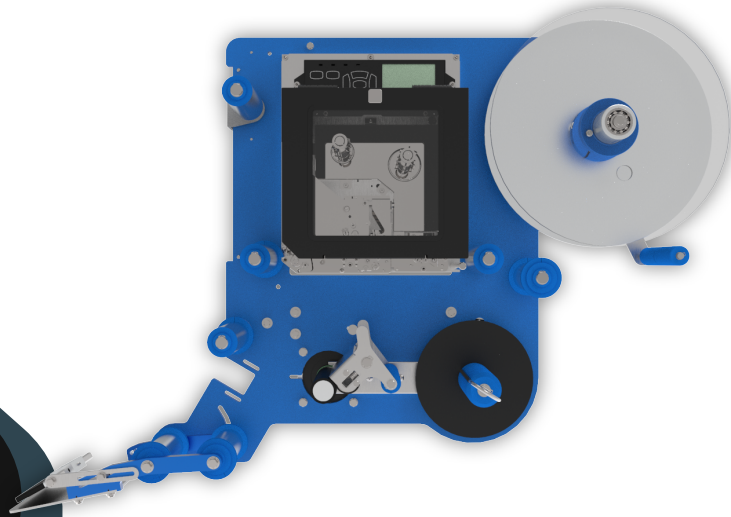

**KLL**

PRINTER AND LABEL  
APPLICATOR

**DIMENSIONS**



**Busch Machinery, Inc.**  
727 E. 20th St.  
Tucson, AZ 85719  
Phone: 800-840-9573 (USA Only)  
Fax: 800-840-6270 (USA Only)  
Phone 520-777-3360  
Fax: 520-777-3369  
E-mail: [sales.inquiries@busch-machinery.com](mailto:sales.inquiries@busch-machinery.com)

## KLL

PRINTER AND LABEL  
APPLICATOR

## SPECS

<b>Labeling speed</b>	Up to 30 m/min
<b>Label width</b>	Up to 110 mm or 170 mm depending on the model
<b>Paper roll outer diameter</b>	Up to 300 mm
<b>Paper roll inner diameter</b>	76 mm
<b>Power supply</b>	350 W 220V-240V, 50Hz* 110V-120V, 60Hz*
<b>Weight</b>	25kg without printer
<b>Dimensions (mm)</b>	910 x 627 x 425
<b>Application modes</b>	Synchronous

\* To change the supply voltage contact us



**Busch Machinery, Inc.**

727 E. 20th St.

Tucson, AZ 85719

Phone: 800-840-9573 (USA Only)

Fax: 800-840-6270 (USA Only)

Phone 520-777-3360

Fax: 520-777-3369

E-mail: [sales.inquiries@busch-machinery.com](mailto:sales.inquiries@busch-machinery.com)